

Opacity ▼

Regional Master Plan Consistency Report

11/23/2009

Prepared by State of New Jersey Highlands Water Protection and Planning Council
100 North Road (Route 513), Chester, NJ 07930
Telephone: (908) 879-6737 Fax: (908) 879-4205



Please consider the environment before printing this report

Disclaimer

Please be advised that any reports generated from the online Consistency Review Application do not constitute a formal Consistency Determination from the Highlands Council. The information contained therein is provided solely for informational purposes and is not to be construed as providing advice, recommendations, endorsements, representations or warranties of any kind whatsoever.

Bethlehem Township ARC Site

STATE ROUTE 173, BETHLEHEM TOWNSHIP, Hunterdon County, Block 00026, Lot 00002

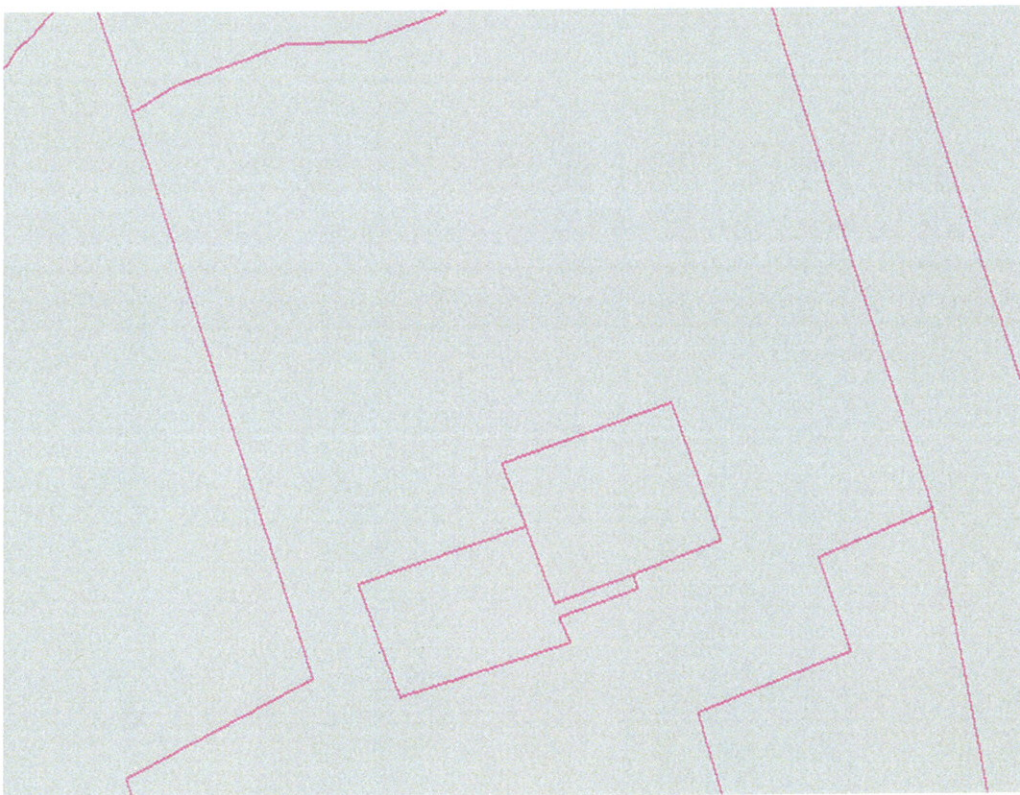

Powered by VERTICES Mapper™



Forest Resource Area

STATE ROUTE 173, BETHLEHEM TOWNSHIP, Hunterdon County, Block 00026, Lot 00002
11/23/2009

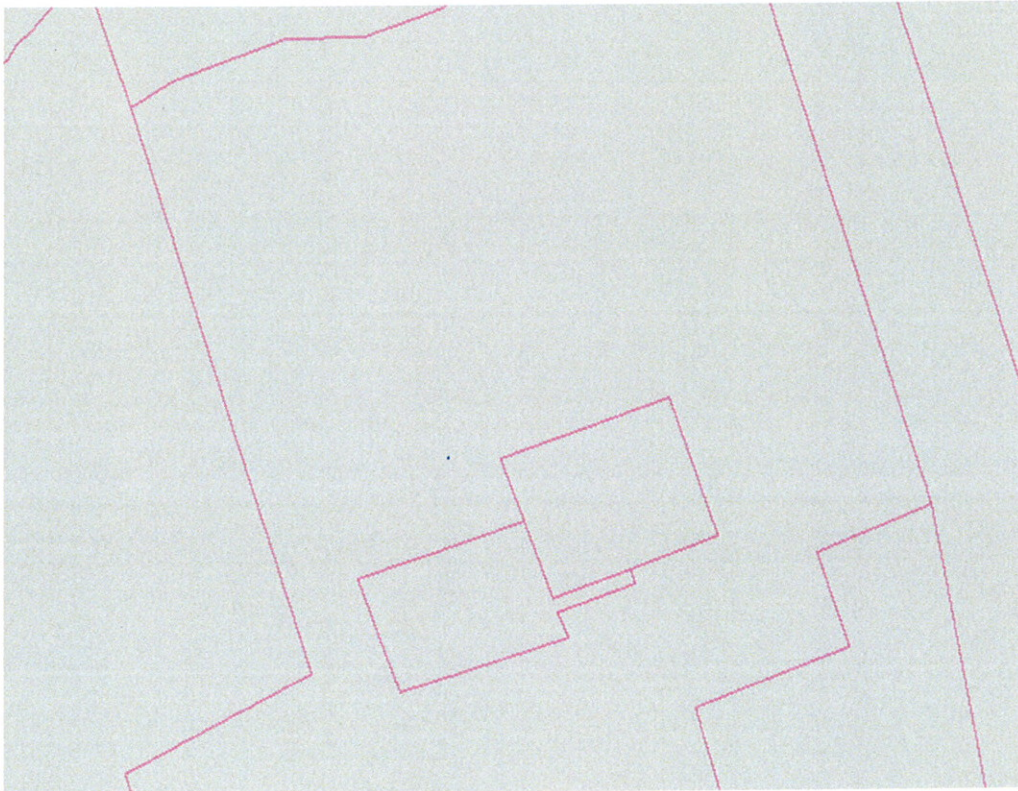

Forest Resource Area: 

The Forest Resource Area data layer is an intensity indicator that captures high ecological value forest areas including those forested lands that exhibit the least fragmentation, which are vital for the maintenance of ecological processes.

Policy 1A5: To prohibit through local development review and Highlands Project Review forest clear-cutting within the Forest Resource Area except in accordance with a Forest Management Plan approved by the State Forester.

Policy 1B3: To limit through local development review and Highlands Project Review deforestation in the Forest Resource Area and forested lands within High Integrity Forest Subwatersheds within the Existing Community Zone to maximum extent practicable.



Forest in Forest Resource Area

STATE ROUTE 173, BETHLEHEM TOWNSHIP, Hunterdon County, Block 00026, Lot 00002
11/23/2009

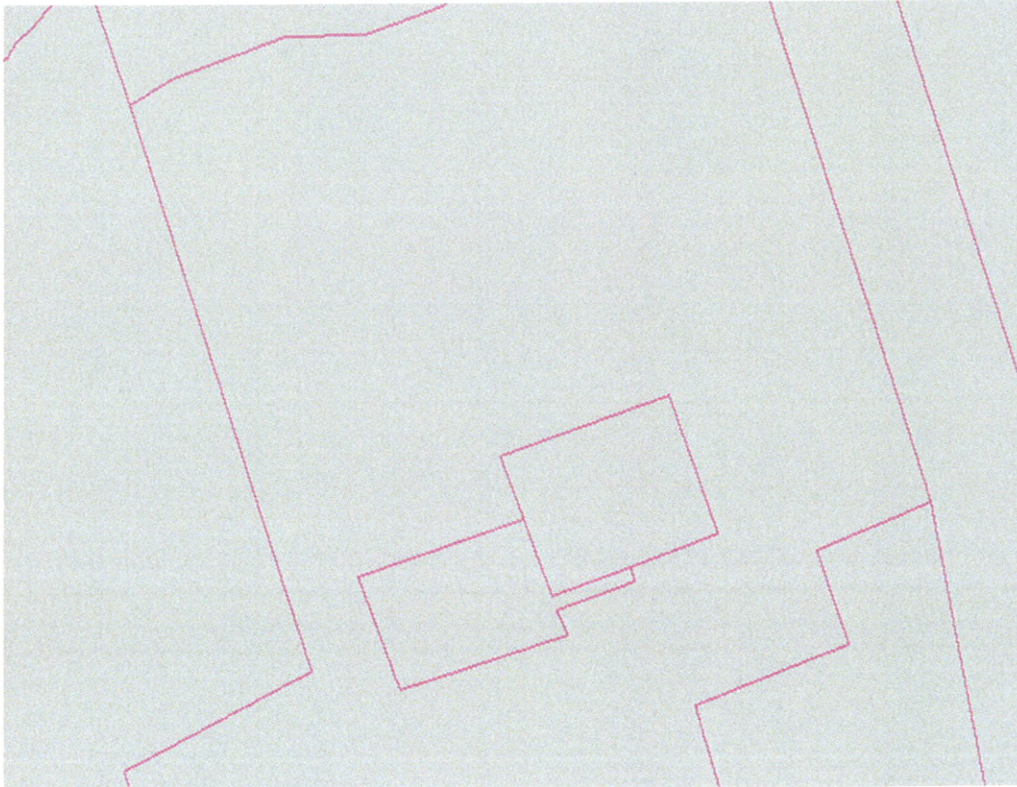

Forest within Forest Resource Area: ■

The Forest in Forest Resource Area data layer illustrates the forested lands located within the spatially delineated Forest Resource Area. The Regional Master plan provides for the protection of the integrity of these forested lands in order to maintain forest ecological function within the Forest Resource Area.

Objective 1A2d: To prohibit through Plan Conformance, local development review and Highlands Project Review the expansion or creation of public water supply systems or public wastewater collection and treatment systems or community-based on-site wastewater facilities into forested areas of the Forest Resource Area within the Planning Area except as provided for in Policy 2J4 with Objectives 2J4a through 2J4d, and Policy 2K3 with Objectives 2K3a through 2K3e, and within the Preservation Area except as provided for in Policy 2I1 and Objectives 2I1a and 2I1b.

Policy 1C1: To require that conforming municipalities and counties address the protection of forested portions of Forest Resource Areas and High Integrity Forest Subwatersheds in their master plans and development regulations.

Policy 5C3: To limit road improvements through local development review and Highlands Project Review where roads are constrained by topography, forested lands or the community character of land uses fronting on the road.



Forest Resource Area in Preservation Area

STATE ROUTE 173, BETHLEHEM TOWNSHIP, Hunterdon County, Block 00026, Lot 00002

11/23/2009

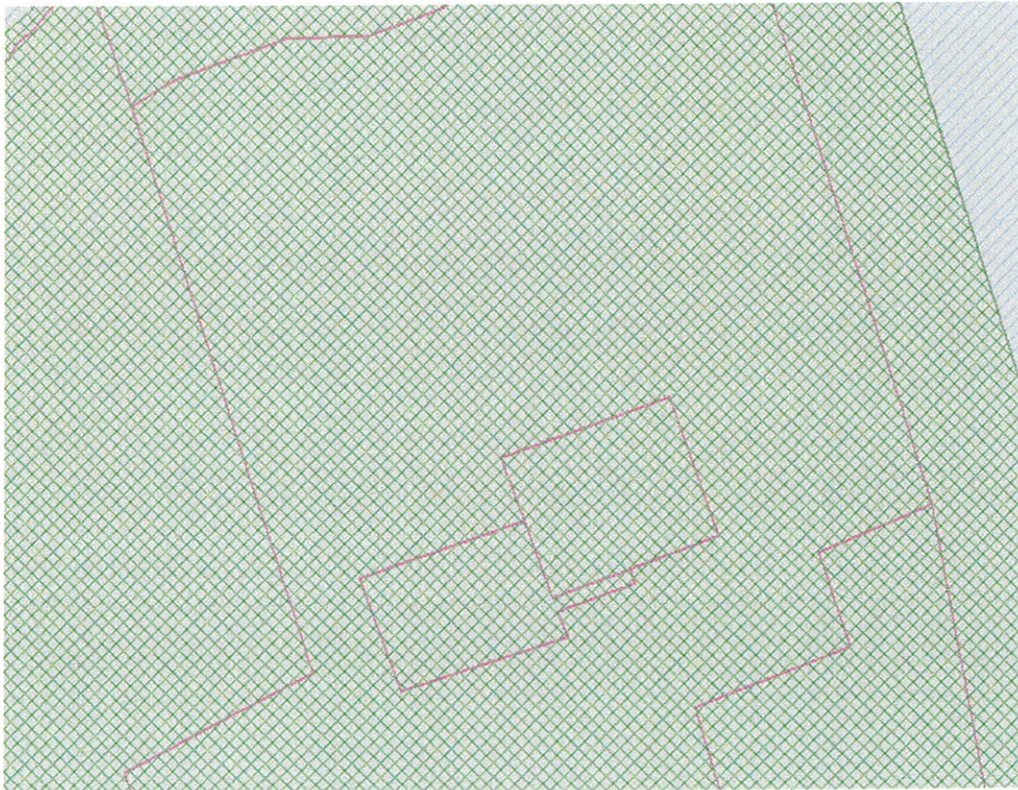

Forest Resource Area:

Planning Area / Preservation Area: Planning Area / Preservation Area

The Forest Resource Area in Preservation Area data layer is an intensity indicator that captures high ecological value forest areas including those forested lands that exhibit the least fragmentation, which are vital for the maintenance of ecological processes within the legislatively delineated Preservation Area. The Regional Master Plan includes protection policies specific to limiting development and the deforestation of all lands within the Forest Resource Area, as a means to protect and enhance forest resources, forest integrity, habitat, and water resources, including reference to NJDEP's Rules for Upland Forest Areas (N.J.A.C. 7:38-3.9).

Policy 1A2: To limit human development in the Forest Resource Area in the Preservation Area in order to protect and enhance forest resources, forest ecosystem integrity, Critical Habitat, and the quantity and quality of water resources.

Objective 1A2c: To prohibit through local development review and Highlands Project Review the deforestation of lands within the Forest Resource Area of the Preservation Area for human development except where authorized as an exemption by the Highlands Act, or is an agricultural or horticultural development as defined at N.J.S.A. 13:20-31 and meets the requirement of that provision of the Highlands Act, or if qualifying as a major Highlands Development, the project must, at a minimum, be in conformance with the NJDEP Preservation Area Rules at N.J.A.C. 7:38-3.9.



Forest in Forest Resource Area in Preservation Area

STATE ROUTE 173, BETHLEHEM TOWNSHIP, Hunterdon County, Block 00026, Lot 00002

11/23/2009

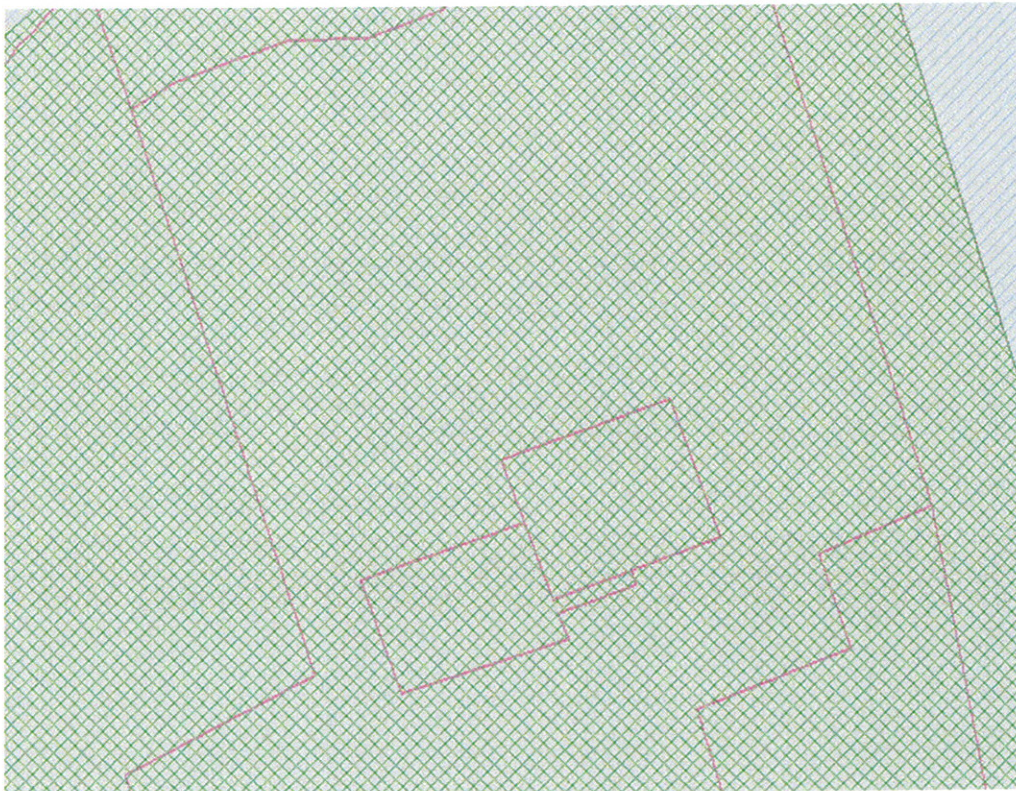

Forest within Forest Resource Area: ■
 Planning Area / Preservation Area: ■ Planning Area / ■ Preservation Area

The Forest in Forest Resource Area in Preservation Area data layer illustrates the forested lands located within the spatially delineated Forest Resource Area of the legislatively delineated Highlands Preservation Area. This data layer illustrates those core, ecologically significant forested lands within the Preservation Area into which the expansion or creation of utilities is prohibited by the Highlands Act, except through approval of a HPAA with waiver pursuant to N.J.A.C. 7:38 and Policy 7G1 which requires protection of sensitive environmental resources within this area.

Objective 211b: The expansion or creation of public water supply systems, public wastewater collection and treatment systems and community on-site treatment facilities in the Preservation Area as approved through a HPAA with waiver pursuant to N.J.A.C. 7:38 and Policy 7G1 shall maximize the protection of sensitive environmental resources including avoidance of Highlands Open Waters buffer areas, Riparian Areas, the forested portion of the Forest Resource Area, agricultural lands of Agricultural Resource Areas, Steep Slopes, Prime Ground Water Recharge Areas, and Critical Habitat.



Forest Resources

STATE ROUTE 173, BETHLEHEM TOWNSHIP, Hunterdon County, Block 00026, Lot 00002
11/23/2009

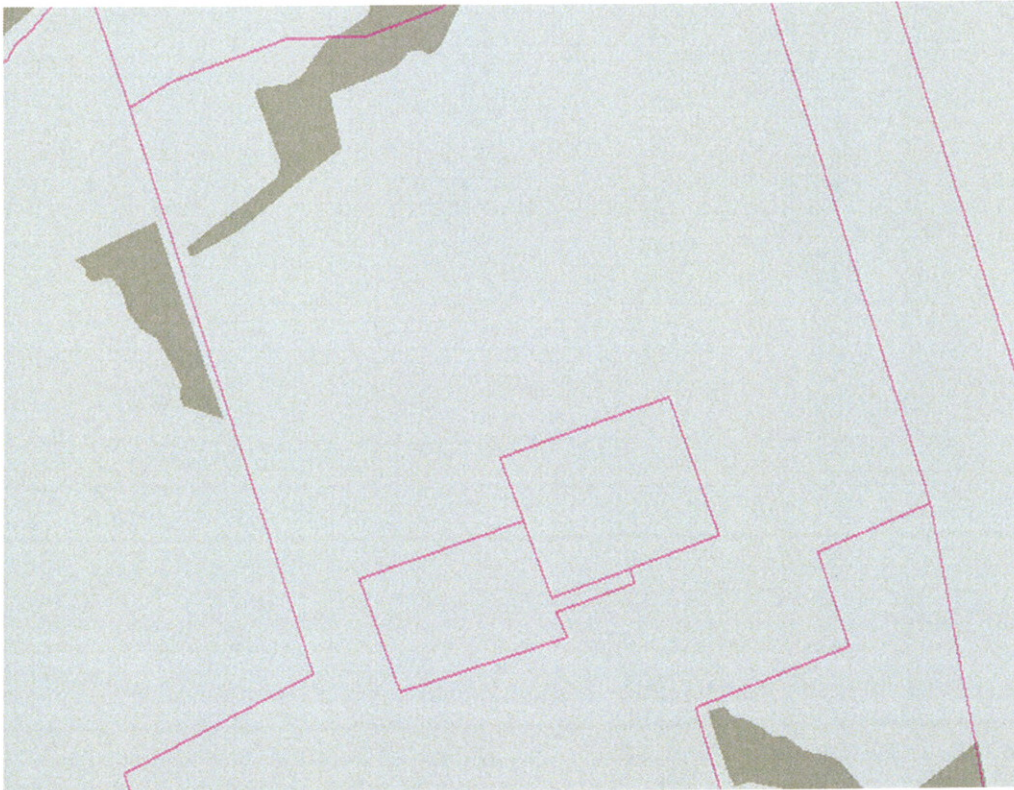

Forest Outside of Forest Resource Area: ■
Forest within Forest Resource Area: ■

Forest Resources represents the Total Forest Area data layer that was extracted from the NJDEP 2002 draft Land Use Land Cover data. This data layer illustrates all upland and wetland forest and scrub/shrub categories (excluding old field) and represents all forested lands within the Region. The Regional Master Plan includes policies that limit clearing of trees within Forest Resources and that seek to protect overall forest resources integrity.

Objective 1B3a: Implementation through Plan Conformance of regulations, which limit the clearing of trees in conjunction with human development to circumstances where the clearing will not diminish the integrity of forest resources.

Policy 1B5: To ensure that forest resources are protected on a site specific basis during local development review and Highlands Project Review.

Objective 1B5a: Applications for local development review and Highlands Project Review require identification of any forest area on and adjacent to a site in accordance with the Highlands Councils Method for Identifying Upland Forest Areas in the Highlands Region.

Policy 1B7: To prohibit clear-cutting of forest lands except pursuant to an approved Forest Management Plan approved by the State Forester.

Policy 1C3: To require that conforming municipalities adopt a tree clearing ordinance consistent with an approved community forestry plan under the New Jersey Forest Service Community Forestry Program as part of the municipal master plan and local development regulations.

Policy 6H1: To protect, restore, or enhance sensitive environmental resources of the Highlands Region, including but not limited to Forests, Critical Habitat, Highlands Open Waters and their buffers, Riparian Areas, Steep Slopes, Prime Ground Water Recharge Areas, Wellhead Protection Areas, and Agricultural Resource Areas.

Policy 6N4: To require through Plan Conformance that municipalities and counties adopt LID best

management practices where disturbance of Highlands resources is proposed, including but not limited to Steep Slopes, forest resources, Critical Habitat, Highlands Open Waters and Riparian Areas, and Prime Ground Water Recharge Areas.



High Integrity Forest Subwatershed

STATE ROUTE 173, BETHLEHEM TOWNSHIP, Hunterdon County, Block 00026, Lot 00002

11/23/2009

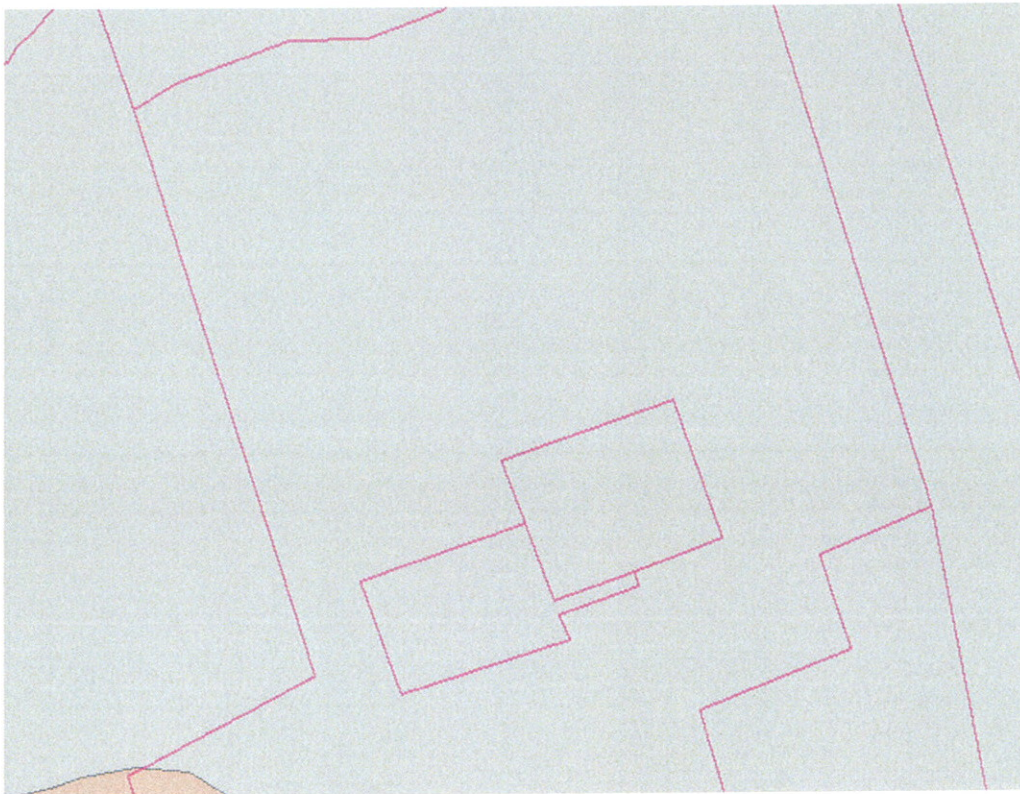

Forest Integrity Value: ■ HIGH ■ MEDIUM ■ LOW

High Integrity Forest Subwatershed is a component of the Forest Integrity Value data layer. This data layer represents forest cover integrity in the Region at the watershed level because forests are important for the protection of water quality and quantity.

Policy 1C1: To require that conforming municipalities and counties address the protection of forested portions of Forest Resource Areas and High Integrity Forest Subwatersheds in their master plans and development regulations.



Highlands Open Waters Protection Buffer

STATE ROUTE 173, BETHLEHEM TOWNSHIP, Hunterdon County, Block 00026, Lot 00002

11/23/2009

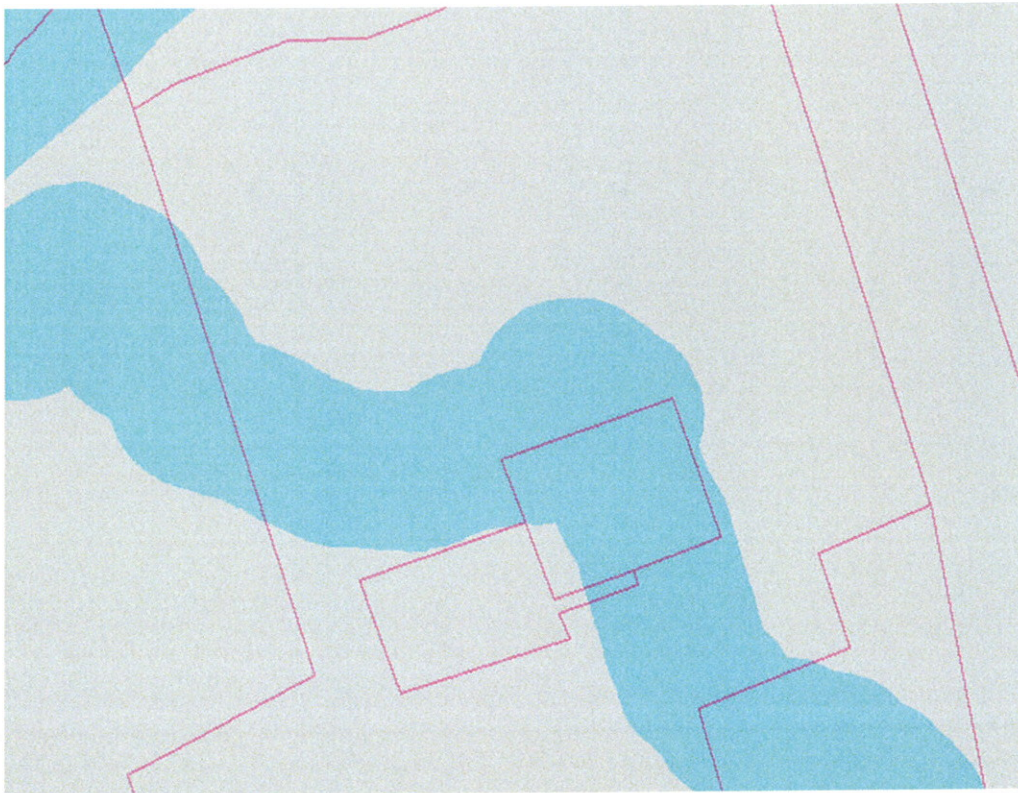

Open Water Protection Area: ■

Highlands Open Waters are defined by the Highlands Act as all springs, streams including intermittent streams, wetlands, and bodies of surface water, whether natural or artificial. The vegetated corridors adjacent to Highlands Open Waters are effective and important tools to protect water quality and aquatic habitat. Protection buffers safeguard Highlands Open Waters from the impacts of adjacent land use practices. The Regional Master Plan includes a protection buffer of 300 feet from the edge of the discernable bank of a Highlands Open Waters feature, or from the centerline where no discernable bank exists.

Policy 1D4: Highlands Open Waters shall include a protection buffer of 300 feet from the edge of the discernable bank of the Highlands Open Waters feature, or from the centerline where no discernable bank exists. With respect to wetlands and other Highlands Open Waters features (e.g., seeps, springs, etc.), the feature shall include a protection buffer of 300 feet from the delineated Letter of Interpretation (LOI) line issued by the NJDEP for wetlands, or from a field-delineated boundary for other features. In areas where existing development or land uses within the protection buffers have reduced or impaired the functional values of the buffers, the Council will seek opportunities to restore the buffer and its functions. Any proposed disturbance shall, through local development review and Highlands Project Review, comply with Highlands Open Waters buffer standards. The protection buffer width for Category 2 streams in the Planning Area may be modified through a Stream Corridor Protection/Restoration Plan, as specified in Objective 1D4i. In approved Redevelopment Areas, the Council may, at its discretion, modify the required buffer, upon a showing of no alternatives, no impact to the functional value of the buffer, and provision of alternative approaches to enhancing or protecting Highlands Open Waters and resources of the buffer area.

Objective 1D4a: Require that all applications for approval through local development review and Highlands Project Review include the identification and mapping of Highlands Open Waters.

Objective 1D4c: Require that proposed development within all Highlands Open Waters buffers (Preservation and Planning Areas) conforms through local development review and Highlands Project Review with the buffer requirements of N.J.A.C. 7:8 (Stormwater Management Rules), N.J.A.C 7:13 (Flood Hazard Area Rules), and N.J.A.C. 7:7 (Freshwater Wetland Rules), and with any applicable requirements of a Regional Stormwater Plan adopted pursuant to N.J.A.C. 7:8

(Stormwater Management Rules).

Objective 1D4i: Develop through Plan Conformance and implement stream corridor or subwatershed-based Stream Corridor Protection/Restoration Plans which shall include Steps 1, 2, and 3, and may include Steps 4 and 5: 1. Identify areas where existing development, land disturbances, or land uses are within Highlands Open Waters buffers have removed or substantially impaired natural vegetation communities, and have significantly reduced or impaired the functional values of Highlands Open Waters buffers. For purposes of this Objective when considering land for conversion to non-agricultural land uses, historic or current agricultural land uses shall not be considered land improvements, development, land disturbances, or land uses; 2. Identify and require opportunities for restoration of areas identified in Step 1 as part of mitigation requirements under a Highlands Act waiver or Objectives 1D4e and 1D4f, and public or nongovernmental restoration/stabilization projects; 3. Identify the extent of stream corridor features that are critical to supporting the functions of a healthy Highlands Open Waters buffer and that extend beyond the buffers required by Objectives 1D4b and 1D4c. The 300 foot buffer in these areas may be expanded to be most protective of these features which may include, but are not limited to, Critical Habitat, pollutant source areas identified through scientific techniques, and steep slopes; 4. Where Highlands Open Waters buffers include areas identified in Step 1, regarding Category 2 surface waters in the Planning Area only, the Stream Corridor Protection/Restoration Plan may identify where, based on scientific analysis of site-specific conditions (e.g., topography, vegetation cover type, habitat, soil type, upstream land uses and pollution inputs, width of floodplain, rate and volume of run-off), a buffer of less than the full 300 feet (but including the undisturbed buffer area at a minimum) is sufficient to maintain or improve the protection of Highlands Open Waters and Riparian Areas. The plan must identify alternative buffers that provide functional buffer values at least equivalent to existing conditions and are no less than 150 feet or no less than the extent allowed in State or municipal regulation (including Objectives 1D4b and 1D4c), whichever is greater. Further, the plan shall include a functional value assessment to ensure that there is no net loss in the overall functional value of the subwatershed's stream buffers. Buffers established through this process shall be determined based on site conditions rather than fixed distances, reflecting findings of the scientific analysis, and shall be used in the site design and development review process regarding determinations of restoration, continued use, or increased use of the disturbed buffer area. Buffer averaging for the purpose of accommodating development proposals is deemed not to meet the requirements of this provision; and 5. Where a proposed Highlands Redevelopment Area would not meet, in full, Objectives 1D4b through 1D4h but affects an undisturbed buffer area determined to not be necessary for the protection of the functional values for Highlands Open Waters buffer (as determined through scientific analysis of site-specific conditions), modification of the undisturbed buffer may be allowed to no less than the extent allowed in State or municipal regulation. However the Council shall first determine that there is no alternative to the proposed reduction of the buffer, and require a showing of no impact to the functional values of the buffer and provision of alternative approaches to enhancing or protecting the Highlands Open Waters and resources of the buffer area. Restoration or enhancement of buffer functional values shall be provided on-site or within the same stream reach to achieve a net improvement of existing buffer functional values.

Objective 1D4j: The Highlands Council may require on a case-by-case basis, through Highlands Project Review, an expansion of the 300 foot buffer to protect the habitat of a water or wetlands-dependant rare, threatened or endangered species, to the minimum expansion necessary to achieve protection of that species.

Objective 1D5b: Limit disturbance of existing natural vegetation or increases in impervious area within High and Moderate Integrity Riparian Areas in any Land Use Capability Zone to the minimum alteration feasible in areas beyond Highlands Open Waters buffer requirements; protect the water quality of adjacent Highlands Open Waters; and maintain or restore habitat value of the Riparian Area.

Objective 2D4a: Development shall not occur in Prime Ground Water Recharge Areas unless necessary to avoid Critical Habitat, Highlands Open Waters Buffers and Moderately and Severely Constrained Steep Slopes.

Objective 2I1b: The expansion or creation of public water supply systems, public wastewater collection and treatment systems and community on-site treatment facilities in the Preservation Area as approved through a HPAA with waiver pursuant to N.J.A.C. 7:38 and Policy 7G1 shall maximize the protection of sensitive environmental resources including avoidance of Highlands Open Waters buffer areas, Riparian Areas, the forested portion of the Forest Resource Area, agricultural lands of Agricultural Resource Areas, Steep Slopes, Prime Ground Water Recharge Areas, and Critical Habitat.

Objective 2J4a: Prohibit new, expanded or extended public water systems within the Protection Zone, the Conservation Zone and the Environmentally-Constrained Sub-zones of the Planning Area unless they are shown to be necessary for and are approved by the Highlands Council for

one or more of the purposes listed below. For approvals regarding parts 1, 2, and 3, the project must maximize the protection of sensitive environmental resources such as Highlands Open Waters buffer areas, Riparian Areas, the forested portion of the Forest Resource Area, agricultural lands of Agricultural Resource Areas, Steep Slopes, Prime Ground Water Recharge Areas and Critical Habitat. For approvals regarding part 3, the project must avoid disturbance of Highlands Open Waters buffer areas, Riparian Areas, Steep Slopes and Critical Habitat, and must minimize disturbance of the forested portion of the Forest Resource Area, agricultural lands of Agricultural Resource Areas, and Prime Ground Water Recharge Areas. The extension or creation of systems shall follow the requirements in Objective 2J4b (parts 2 and 3). The applicable purposes are: 1. To address through a waiver under Policy 7G1 or 7G2 a documented existing or imminent threat to public health and safety from contaminated domestic and other on-site water supplies that is of sufficient scale to justify a public water supply and where no alternative is feasible that would sufficiently assure long-term protection of public health and safety. Such needs shall have highest priority for allocation of existing system capacity; 2. To address development permitted through a Highlands Redevelopment Area or takings waiver under Policy 7G1 or 7G2; or 3. To serve a cluster development that meets all requirements of Objective 2J4b.

Objective 2K3c: Prohibit new, expanded or extended public wastewater collection and treatment systems and community on-site treatment facilities within the Protection Zone, the Conservation Zone and the Environmentally-Constrained Sub-zones of the Planning Area unless they are shown to be necessary for and are approved by the Highlands Council for one or more of the purposes listed below. For approvals regarding parts 1, 2, and 3, the project must maximize the protection of sensitive environmental resources such as Highlands Open Waters buffer areas, Riparian Areas, the forested portion of the Forest Resource Area, agricultural lands of Agricultural Resource Areas, Steep Slopes, Prime Ground Water Recharge Areas and Critical Habitat. For approvals regarding part 3, the project must avoid disturbance of Highlands Open Waters buffer areas, Riparian Areas, Steep Slopes and Critical Habitat, and must minimize disturbance of the forested portion of the Forest Resource Area, agricultural lands of Agricultural Resource Areas, and Prime Ground Water Recharge Areas. The choice of extension or creation of systems shall follow the requirements in Objective 2K3d (2 and 3). The applicable purposes are: 1. To address through a waiver under Policy 7G1 or 7G2 a documented existing or imminent threat to public health and safety from a pattern of failing septic systems (where the failing systems cannot reasonably be addressed through rehabilitation or replacement) or highly concentrated septic systems, where the threat is of sufficient scale to justify a public wastewater collection and treatment system or community on-site treatment facility and where no alternative is feasible that would sufficiently assure long-term protection of public health and safety. To address other issues of public health and safety, such needs shall have highest priority for allocation of existing system capacity; 2. To address development permitted through a Highlands Redevelopment Area or takings waiver under Policy 7G1 or 7G2; or 3. To serve a cluster development that meets all requirements of Objective 2K3d.

Policy 6H1: To protect, restore, or enhance sensitive environmental resources of the Highlands Region, including but not limited to Forests, Critical Habitat, Highlands Open Waters and their buffers, Riparian Areas, Steep Slopes, Prime Ground Water Recharge Areas, Wellhead Protection Areas, and Agricultural Resource Areas.

Policy 6N4: To require through Plan Conformance that municipalities and counties adopt LID best management practices where disturbance of Highlands resources is proposed, including but not limited to Steep Slopes, forest resources, Critical Habitat, Highlands Open Waters and Riparian Areas, and Prime Ground Water Recharge Areas.



Highlands Open Waters Buffers in Preservation Area

STATE ROUTE 173, BETHLEHEM TOWNSHIP, Hunterdon County, Block 00026, Lot 00002

11/23/2009

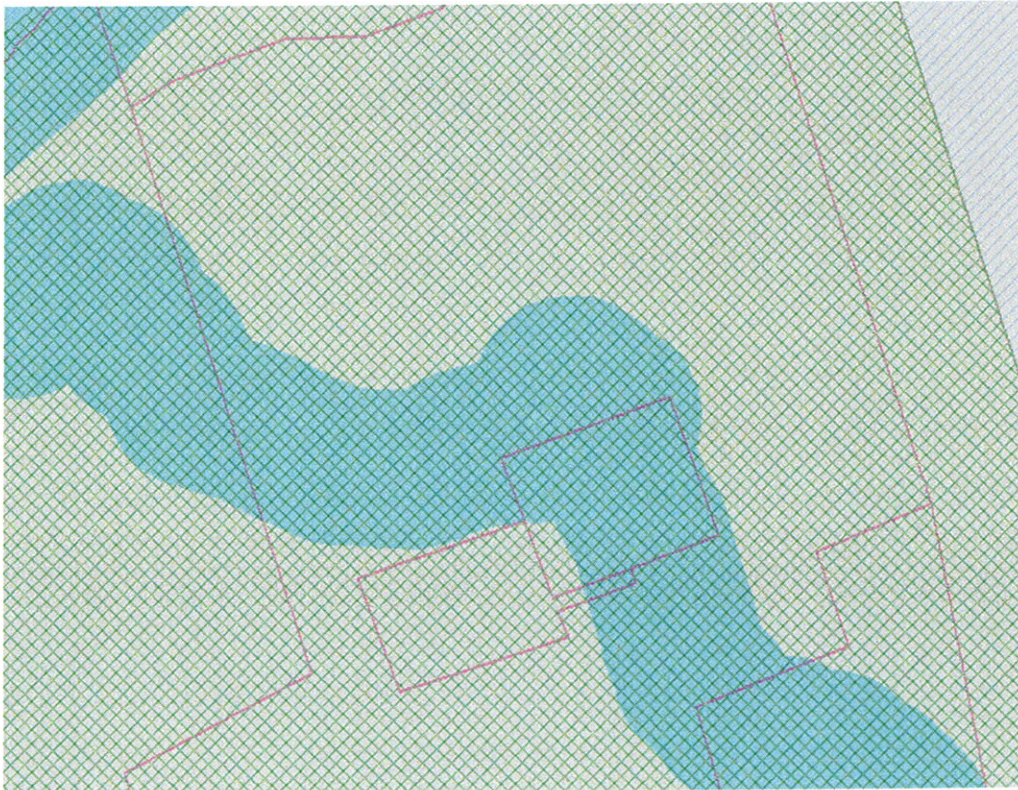

Open Water Protection Area: ■

Planning Area / Preservation Area: ■ Planning Area / ■ Preservation Area

Includes all Highlands Open Waters protection buffers within the Preservation Area, which are regulated by the Highlands Preservation Area rules at N.J.A.C. 7:38.

Objective 1D4b: Preservation Area buffers for Highlands Open Waters shall comply with the Highlands Preservation Area rules at N.J.A.C. 7:38, which provide that all major Highlands developments are prohibited within Highlands Open Waters and its adjacent 300 foot buffer in the Preservation Area except for linear development, which may be permitted provided that there is no feasible alternative for the linear development outside Highlands Open Waters or its buffer. Structures or other land improvements existing within Highlands Open Waters buffer in the Preservation Area on August 10, 2004 may remain, provided that the area of disturbance is not increased other than through a HPAA. For purposes of this Objective when considering land for conversion to non-agricultural land uses, historic or current agricultural land uses shall not be considered pland improvements,q pdevelopment,q pland disturbances,q or pland uses.q



Riparian Area

STATE ROUTE 173, BETHLEHEM TOWNSHIP, Hunterdon County, Block 00026, Lot 00002
11/23/2009

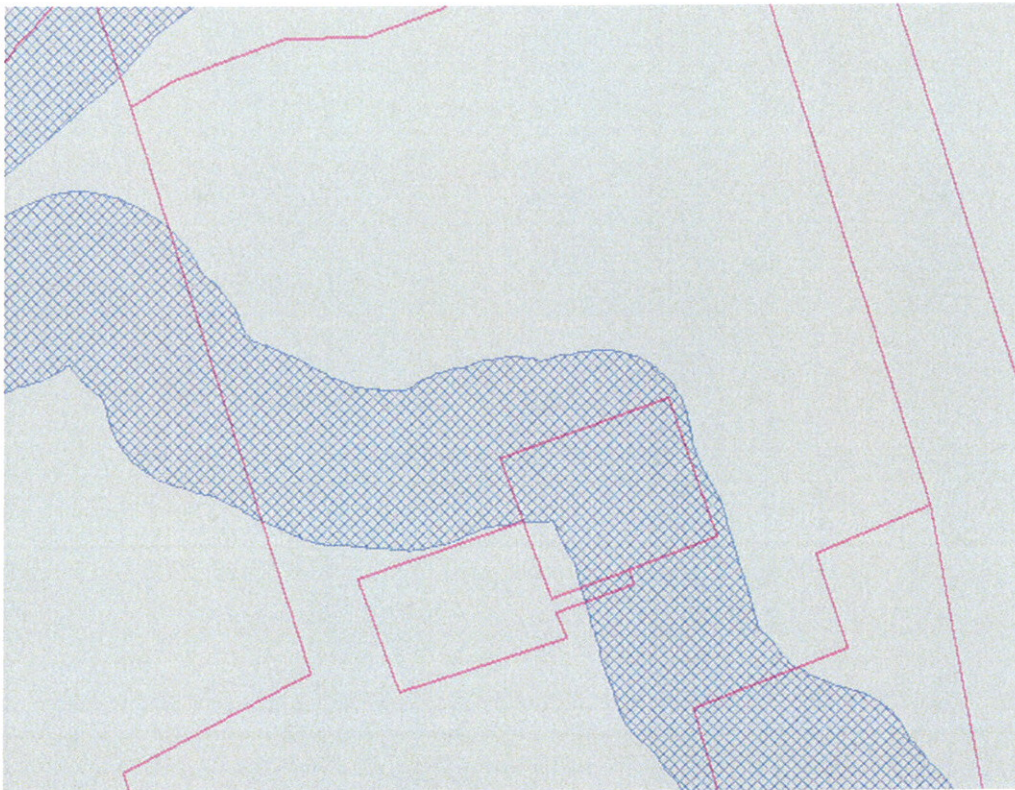

Riparian Corridor Integrity Score: HIGH MODERATE LOW

Riparian Areas are areas adjacent to, and hydrologically interconnected with, rivers and streams. They are areas that exhibit periodic inundation or saturation of soils, are subject to periodic flooding, and include wildlife corridors within 300 feet of a surface water feature. Riparian Areas serve as an interface between surface water bodies and terrestrial ecosystems and play a critical role in maintaining the quality and ecological integrity of Highlands Open Waters.

Objective 1D5b: Limit disturbance of existing natural vegetation or increases in impervious area within High and Moderate Integrity Riparian Areas in any Land Use Capability Zone to the minimum alteration feasible in areas beyond Highlands Open Waters buffer requirements; protect the water quality of adjacent Highlands Open Waters; and maintain or restore habitat value of the Riparian Area.

Objective 1D5e: Implement Low Impact Development Best Management Practices for any development activity proposed within a Riparian Area, which minimize both alterations of natural vegetation and increases in impervious area, in compliance with Policies 6N3 and 6N4 and provide for mitigation through restoration of impaired Riparian Areas in the same HUC14 subwatershed.

Objective 1D5f: Require that development within Riparian Areas conforms through local development review and Highlands Project Review to any applicable requirements of a Regional Stormwater Plan adopted pursuant to N.J.A.C. 7:8 (Stormwater Management Rules).

Objective 1D5g: Require identification and implementation of opportunities where the restoration and enhancement of previously impaired Riparian Areas are feasible and appropriate as mitigation to any allowable modification to Riparian Area requirements.

Objective 2I1b: The expansion or creation of public water supply systems, public wastewater collection and treatment systems and community on-site treatment facilities in the Preservation Area as approved through a HPA with waiver pursuant to N.J.A.C. 7:38 and Policy 7G1 shall maximize the protection of sensitive environmental resources including avoidance of Highlands Open Waters buffer areas, Riparian Areas, the forested portion of the Forest Resource Area, agricultural lands of Agricultural Resource Areas, Steep Slopes, Prime Ground Water Recharge Areas, and Critical Habitat.

Objective 2J4a: Prohibit new, expanded or extended public water systems within the Protection Zone, the Conservation Zone and the Environmentally-Constrained Sub-zones of the Planning Area unless they are shown to be necessary for and are approved by the Highlands Council for one or more of the purposes listed below. For approvals regarding parts 1, 2, and 3, the project must maximize the protection of sensitive environmental resources such as Highlands Open Waters buffer areas, Riparian Areas, the forested portion of the Forest Resource Area, agricultural lands of Agricultural Resource Areas, Steep Slopes, Prime Ground Water Recharge Areas and Critical Habitat. For approvals regarding part 3, the project must avoid disturbance of Highlands Open Waters buffer areas, Riparian Areas, Steep Slopes and Critical Habitat, and must minimize disturbance of the forested portion of the Forest Resource Area, agricultural lands of Agricultural Resource Areas, and Prime Ground Water Recharge Areas. The extension or creation of systems shall follow the requirements in Objective 2J4b (parts 2 and 3). The applicable purposes are: 1. To address through a waiver under Policy 7G1 or 7G2 a documented existing or imminent threat to public health and safety from contaminated domestic and other on-site water supplies that is of sufficient scale to justify a public water supply and where no alternative is feasible that would sufficiently assure long-term protection of public health and safety. Such needs shall have highest priority for allocation of existing system capacity; 2. To address development permitted through a Highlands Redevelopment Area or takings waiver under Policy 7G1 or 7G2; or 3. To serve a cluster development that meets all requirements of Objective 2J4b.

Objective 2K3c: Prohibit new, expanded or extended public wastewater collection and treatment systems and community on-site treatment facilities within the Protection Zone, the Conservation Zone and the Environmentally-Constrained Sub-zones of the Planning Area unless they are shown to be necessary for and are approved by the Highlands Council for one or more of the purposes listed below. For approvals regarding parts 1, 2, and 3, the project must maximize the protection of sensitive environmental resources such as Highlands Open Waters buffer areas, Riparian Areas, the forested portion of the Forest Resource Area, agricultural lands of Agricultural Resource Areas, Steep Slopes, Prime Ground Water Recharge Areas and Critical Habitat. For approvals regarding part 3, the project must avoid disturbance of Highlands Open Waters buffer areas, Riparian Areas, Steep Slopes and Critical Habitat, and must minimize disturbance of the forested portion of the Forest Resource Area, agricultural lands of Agricultural Resource Areas, and Prime Ground Water Recharge Areas. The choice of extension or creation of systems shall follow the requirements in Objective 2K3d (2 and 3). The applicable purposes are: 1. To address through a waiver under Policy 7G1 or 7G2 a documented existing or imminent threat to public health and safety from a pattern of failing septic systems (where the failing systems cannot reasonably be addressed through rehabilitation or replacement) or highly concentrated septic systems, where the threat is of sufficient scale to justify a public wastewater collection and treatment system or community on-site treatment facility and where no alternative is feasible that would sufficiently assure long-term protection of public health and safety. To address other issues of public health and safety, such needs shall have highest priority for allocation of existing system capacity; 2. To address development permitted through a Highlands Redevelopment Area or takings waiver under Policy 7G1 or 7G2; or 3. To serve a cluster development that meets all requirements of Objective 2K3d.

Policy 6H1: To protect, restore, or enhance sensitive environmental resources of the Highlands Region, including but not limited to Forests, Critical Habitat, Highlands Open Waters and their buffers, Riparian Areas, Steep Slopes, Prime Ground Water Recharge Areas, Wellhead Protection Areas, and Agricultural Resource Areas.

Policy 6N4: To require through Plan Conformance that municipalities and counties adopt LID best management practices where disturbance of Highlands resources is proposed, including but not limited to Steep Slopes, forest resources, Critical Habitat, Highlands Open Waters and Riparian Areas, and Prime Ground Water Recharge Areas.



Riparian Area in Protection Zone

STATE ROUTE 173, BETHLEHEM TOWNSHIP, Hunterdon County, Block 00026, Lot 00002
11/23/2009



Protection Zone	Conservation Zone
Existing Community Zone	Lake Community Subzone
Conservation Environmentally Constrained Subzone	Existing Community Environmentally Constrained Subzone
Wildlife Management	

Riparian Corridor Integrity Score: HIGH MODERATE LOW

Includes all Riparian Areas within the Protection Zone.

Objective 1D5c: Prohibit modifications to Riparian Areas in the Protection Zone except where a waiver is approved by the NJDEP or the Highlands Council under Policy 7G1 or 7G2.



Riparian Corridor Integrity Score - High

STATE ROUTE 173, BETHLEHEM TOWNSHIP, Hunterdon County, Block 00026, Lot 00002
11/23/2009

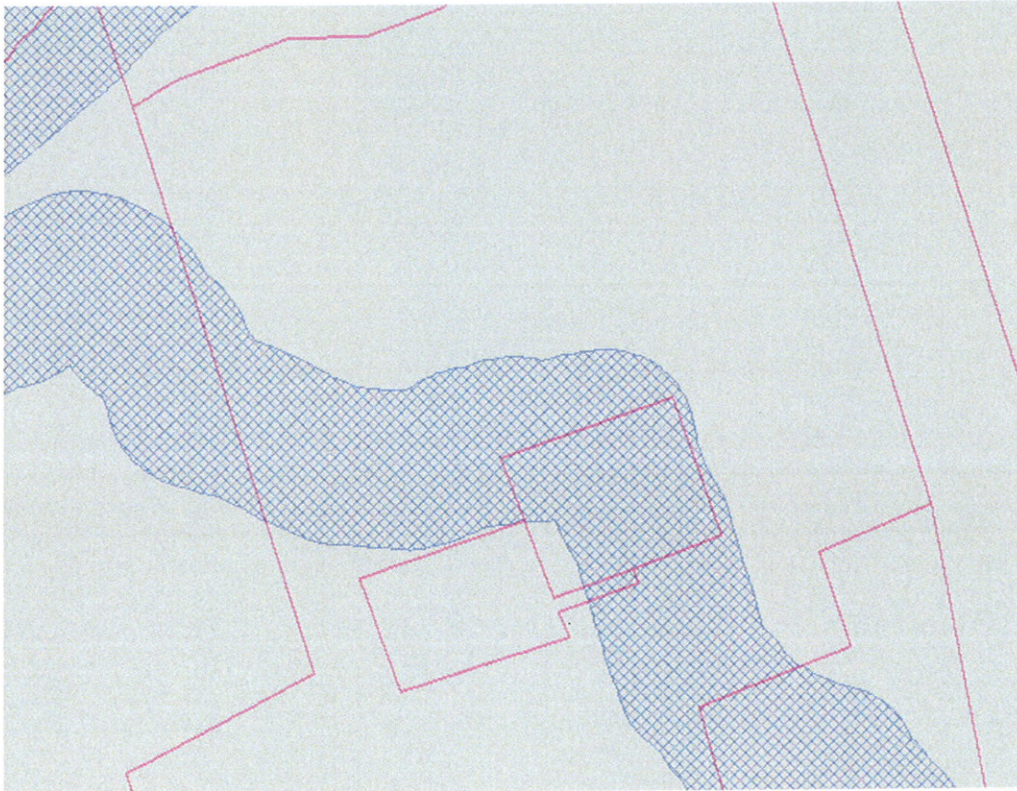

Riparian Corridor Integrity Score: HIGH MODERATE LOW

These areas include watersheds with Riparian Areas that exhibit predominantly natural vegetation including high quality habitat for rare, threatened, and endangered water/wetland dependent species, and a generally low incidence of impervious area, agricultural uses and/or road crossings.

Objective 1D5b: Limit disturbance of existing natural vegetation or increases in impervious area within High and Moderate Integrity Riparian Areas in any Land Use Capability Zone to the minimum alteration feasible in areas beyond Highlands Open Waters buffer requirements; protect the water quality of adjacent Highlands Open Waters; and maintain or restore habitat value of the Riparian Area.

Area unless they are shown to be necessary for and are approved by the Highlands Council for one or more of the purposes listed below. For approvals regarding parts 1, 2, and 3, the project must maximize the protection of sensitive environmental resources such as Highlands Open Waters buffer areas, Riparian Areas, the forested portion of the Forest Resource Area, agricultural lands of Agricultural Resource Areas, Steep Slopes, Prime Ground Water Recharge Areas and Critical Habitat. For approvals regarding part 3, the project must avoid disturbance of Highlands Open Waters buffer areas, Riparian Areas, Steep Slopes and Critical Habitat, and must minimize disturbance of the forested portion of the Forest Resource Area, agricultural lands of Agricultural Resource Areas, and Prime Ground Water Recharge Areas. The extension or creation of systems shall follow the requirements in Objective 2J4b (parts 2 and 3). The applicable purposes are: 1. To address through a waiver under Policy 7G1 or 7G2 a documented existing or imminent threat to public health and safety from contaminated domestic and other on-site water supplies that is of sufficient scale to justify a public water supply and where no alternative is feasible that would sufficiently assure long-term protection of public health and safety. Such needs shall have highest priority for allocation of existing system capacity; 2. To address development permitted through a Highlands Redevelopment Area or takings waiver under Policy 7G1 or 7G2; or 3. To serve a cluster development that meets all requirements of Objective 2J4b.

Objective 2K3c: Prohibit new, expanded or extended public wastewater collection and treatment systems and community on-site treatment facilities within the Protection Zone, the Conservation Zone and the Environmentally-Constrained Sub-zones of the Planning Area unless they are shown to be necessary for and are approved by the Highlands Council for one or more of the purposes listed below. For approvals regarding parts 1, 2, and 3, the project must maximize the protection of sensitive environmental resources such as Highlands Open Waters buffer areas, Riparian Areas, the forested portion of the Forest Resource Area, agricultural lands of Agricultural Resource Areas, Steep Slopes, Prime Ground Water Recharge Areas and Critical Habitat. For approvals regarding part 3, the project must avoid disturbance of Highlands Open Waters buffer areas, Riparian Areas, Steep Slopes and Critical Habitat, and must minimize disturbance of the forested portion of the Forest Resource Area, agricultural lands of Agricultural Resource Areas, and Prime Ground Water Recharge Areas. The choice of extension or creation of systems shall follow the requirements in Objective 2K3d (2 and 3). The applicable purposes are: 1. To address through a waiver under Policy 7G1 or 7G2 a documented existing or imminent threat to public health and safety from a pattern of failing septic systems (where the failing systems cannot reasonably be addressed through rehabilitation or replacement) or highly concentrated septic systems, where the threat is of sufficient scale to justify a public wastewater collection and treatment system or community on-site treatment facility and where no alternative is feasible that would sufficiently assure long-term protection of public health and safety. To address other issues of public health and safety, such needs shall have highest priority for allocation of existing system capacity; 2. To address development permitted through a Highlands Redevelopment Area or takings waiver under Policy 7G1 or 7G2; or 3. To serve a cluster development that meets all requirements of Objective 2K3d.

Policy 6H1: To protect, restore, or enhance sensitive environmental resources of the Highlands Region, including but not limited to Forests, Critical Habitat, Highlands Open Waters and their buffers, Riparian Areas, Steep Slopes, Prime Ground Water Recharge Areas, Wellhead Protection Areas, and Agricultural Resource Areas.

Policy 6N4: To require through Plan Conformance that municipalities and counties adopt LID best management practices where disturbance of Highlands resources is proposed, including but not limited to Steep Slopes, forest resources, Critical Habitat, Highlands Open Waters and Riparian Areas, and Prime Ground Water Recharge Areas.



Potential or Limited Constrained Slopes

STATE ROUTE 173, BETHLEHEM TOWNSHIP, Hunterdon County, Block 00026, Lot 00002
11/23/2009



Potential or Limited Constrained Slopes: ■

All non-Riparian lands having a slope 15-20%, which are not forested. Constrained Slopes are those whose soils are a) highly susceptible to erosion, b) shallow depth to bedrock, or c) have a Soil Capability Class indicative of wet or stony soils. Limited Constrained Slopes are those whose soils are not highly susceptible to erosion, do not have a shallow depth to bedrock or a Soil Capability Class indicative of wet or stony soils. The use of the word "Potential" is indicative of the fact that soil properties shall be determined at the time of site plan review.

Policy 1E9: To require through local development review and Highlands Project Review the use of Low Impact Best Development Practices for any land disturbance or human development within areas, which are Constrained or Limited Constrained Slopes, or that involves an approved disturbance of a Severely Constrained or Moderately Constrained Slope.



Severely or Moderately Constrained Slopes

STATE ROUTE 173, BETHLEHEM TOWNSHIP, Hunterdon County, Block 00026, Lot 00002
11/23/2009

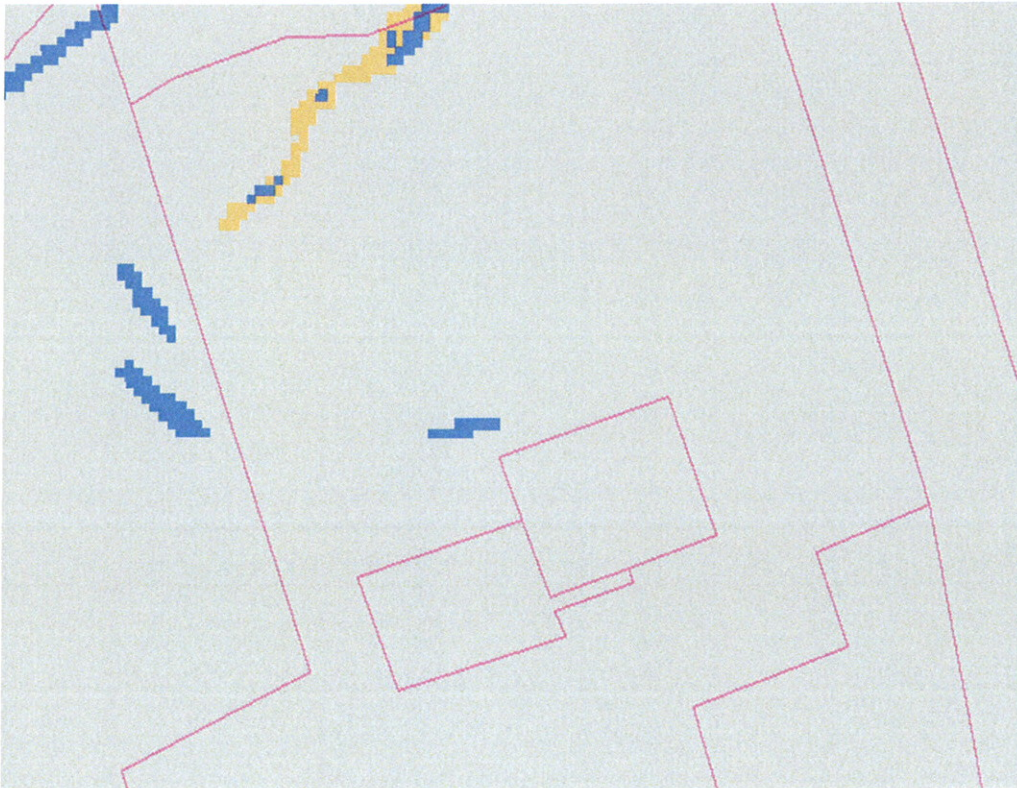

Moderately Constrained Slopes: ■
Severely Constrained Slopes: ■

Severely Constrained Slopes are all lands with slopes of 20% or greater and lands within Riparian Areas with slopes of 10% or greater. Moderately Constrained Slopes are all non-Riparian Area lands having a slope of 15% to less than 20% which are forested.

Policy 1E8: To prohibit through local development review and Highlands Project Review land disturbance within areas which are Severely Constrained Slopes and Moderately Constrained Slopes, except for linear development in both the Preservation and Planning Areas that meets the requirements of N.J.A.C. 7:38-3.8(c)1-4.

Objective 2D4a: Development shall not occur in Prime Ground Water Recharge Areas unless necessary to avoid Critical Habitat, Highlands Open Waters Buffers and Moderately and Severely Constrained Steep Slopes.



Critical Wildlife Habitat

STATE ROUTE 173, BETHLEHEM TOWNSHIP, Hunterdon County, Block 00026, Lot 00002
11/23/2009

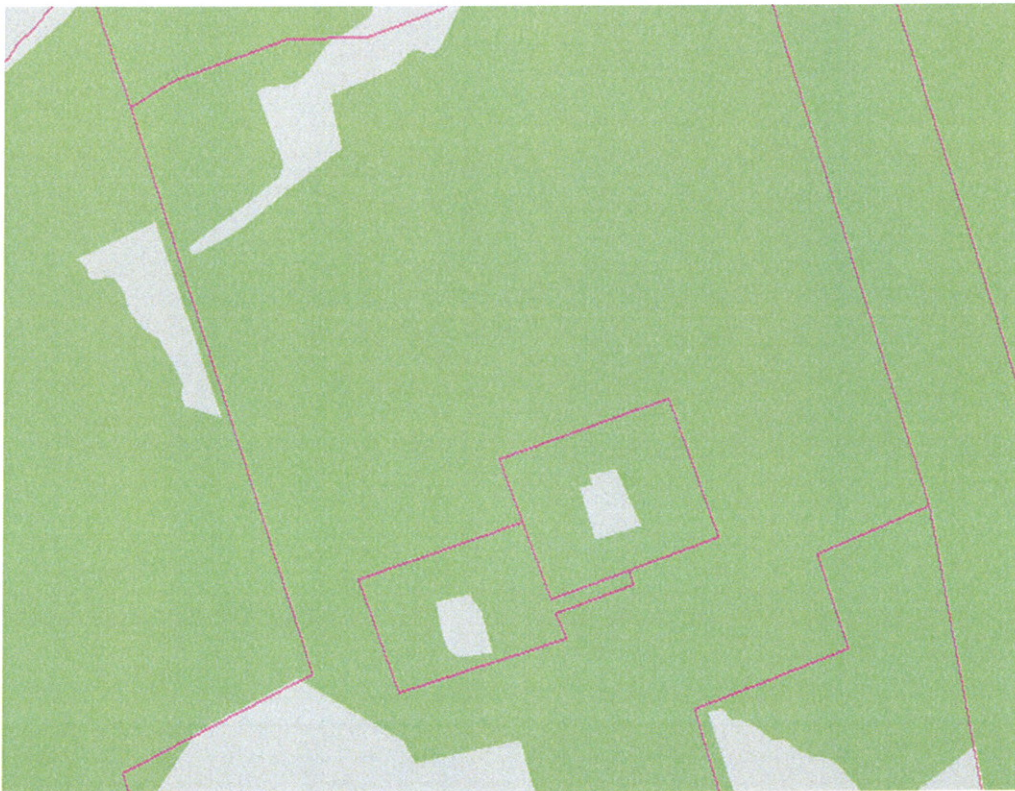

Critical Wildlife Habitat: ■

Critical Wildlife Habitat data layer illustrates habitat areas that are critical for the survival of rare, threatened or endangered wildlife species of the Highlands Region. Critical Wildlife Habitat areas are lands within the NJDEPos Landscape Project Version 3 that are Landscape Rank 3 through 5 and Landscape Rank 2 with Highlands Conservation Rank of Critically Significant or Significant in the Planning Area.

Policy 1A2: To limit human development in the Forest Resource Area in the Preservation Area in order to protect and enhance forest resources, forest ecosystem integrity, Critical Habitat, and the quantity and quality of water resources.

Policy 1F2: To prohibit through Plan Conformance, local development review and Highlands Project Review the direct impact of new human development or expansion or increased intensity of existing development within Critical Habitat.

Policy 1F5: To establish a Habitat Conservation and Management Program, including minimum performance standards and criteria for the protection, enhancement, and restoration of lands within Critical Habitat.

Policy 1F6: To require that applications for any local development review and Highlands Project Review for Critical Habitat be subject to minimum standards and criteria outlined in the Habitat Conservation and Management Plan.

Objective 1F6a: Prohibit direct impacts from new development or expansion or increased intensity of existing development that will jeopardize the continued existence of, or result in the likelihood of the destruction or adverse modification of Critical Habitat, except as permitted through the issuance of a waiver under Policy 7G1 or 7G2.

Objective 1F6b: Prohibit indirect impacts from activity that is off-site, adjacent to, or within Critical Habitat that will jeopardize the continued existence of, or result in the likelihood of the destruction or adverse modification of Critical Habitat, except as permitted through the issuance of a waiver under Policy 7G1 or 7G2.

Objective 1F6c: Waiver applications under Policy 7G2 for local development in a municipality with a Council-approved Critical Habitat Conservation and Management Plan shall be subject to the minimum standards and criteria for waiver provisions as set forth in the plan, to the maximum extent practicable.

Objective 1F6d: Waiver applications under Policy 7G2 for development in a municipality without a Council-approved Critical Habitat Conservation and Management Plan shall be subject to the Low Impact Development Best Management Practices required in Objective 1F5b.

Objective 1F6f: A Critical Wildlife Habitat area or Significant Natural Area delineation may be modified if an applicant can demonstrate, to the satisfaction of the Highlands Council in coordination with the NJDEP's Endangered and Nongame Species Program or Natural Heritage Program, that: 1. The nature of the site is such that it does not provide habitat for species of concern; 2. The species of concern are not present on the site during any critical part of their life cycle, do not depend upon the site for food, shelter or breeding, and the habitat; on the site is either unsuitable or not critical to species recovery in the Region; or 3. Existing land uses present a human, natural or development barrier to the use of the site by species of concern. Requirements for demonstrating the above criteria shall be included in the Critical Habitat Conservation and Management Plan.

Objective 2D4a: Development shall not occur in Prime Ground Water Recharge Areas unless necessary to avoid Critical Habitat, Highlands Open Waters Buffers and Moderately and Severely Constrained Steep Slopes.

Objective 2I1b: The expansion or creation of public water supply systems, public wastewater collection and treatment systems and community on-site treatment facilities in the Preservation Area as approved through a HPA with waiver pursuant to N.J.A.C. 7:38 and Policy 7G1 shall maximize the protection of sensitive environmental resources including avoidance of Highlands Open Waters buffer areas, Riparian Areas, the forested portion of the Forest Resource Area, agricultural lands of Agricultural Resource Areas, Steep Slopes, Prime Ground Water Recharge Areas, and Critical Habitat.

Objective 2J4a: Prohibit new, expanded or extended public water systems within the Protection Zone, the Conservation Zone and the Environmentally-Constrained Sub-zones of the Planning Area unless they are shown to be necessary for and are approved by the Highlands Council for one or more of the purposes listed below. For approvals regarding parts 1, 2, and 3, the project must maximize the protection of sensitive environmental resources such as Highlands Open Waters buffer areas, Riparian Areas, the forested portion of the Forest Resource Area, agricultural lands of Agricultural Resource Areas, Steep Slopes, Prime Ground Water Recharge Areas and Critical Habitat. For approvals regarding part 3, the project must avoid disturbance of Highlands Open Waters buffer areas, Riparian Areas, Steep Slopes and Critical Habitat, and must minimize disturbance of the forested portion of the Forest Resource Area, agricultural lands of Agricultural Resource Areas, and Prime Ground Water Recharge Areas. The extension or creation of systems shall follow the requirements in Objective 2J4b (parts 2 and 3). The applicable purposes are: 1. To address through a waiver under Policy 7G1 or 7G2 a documented existing or imminent threat to public health and safety from contaminated domestic and other on-site water supplies that is of sufficient scale to justify a public water supply and where no alternative is feasible that would sufficiently assure long-term protection of public health and safety. Such needs shall have highest priority for allocation of existing system capacity; 2. To address development permitted through a Highlands Redevelopment Area or takings waiver under Policy 7G1 or 7G2; or 3. To serve a cluster development that meets all requirements of Objective 2J4b.

Objective 2K3c: Prohibit new, expanded or extended public wastewater collection and treatment systems and community on-site treatment facilities within the Protection Zone, the Conservation Zone and the Environmentally-Constrained Sub-zones of the Planning Area unless they are shown to be necessary for and are approved by the Highlands Council for one or more of the purposes listed below. For approvals regarding parts 1, 2, and 3, the project must maximize the protection of sensitive environmental resources such as Highlands Open Waters buffer areas, Riparian Areas, the forested portion of the Forest Resource Area, agricultural lands of Agricultural Resource Areas, Steep Slopes, Prime Ground Water Recharge Areas and Critical Habitat. For approvals regarding part 3, the project must avoid disturbance of Highlands Open Waters buffer areas, Riparian Areas, Steep Slopes and Critical Habitat, and must minimize disturbance of the forested portion of the Forest Resource Area, agricultural lands of Agricultural Resource Areas, and Prime Ground Water Recharge Areas. The choice of extension or creation of systems shall follow the requirements in Objective 2K3d (2 and 3). The applicable purposes are: 1. To address through a waiver under Policy 7G1 or 7G2 a documented existing or imminent threat to public health and safety from a pattern of failing septic systems (where the failing systems cannot reasonably be addressed through rehabilitation or replacement) or highly concentrated septic systems, where the threat is of sufficient scale to justify a public wastewater collection and treatment system or community on-site treatment facility and where no alternative is feasible that would sufficiently assure long-term

protection of public health and safety. To address other issues of public health and safety, such needs shall have highest priority for allocation of existing system capacity; 2. To address development permitted through a Highlands Redevelopment Area or takings waiver under Policy 7G1 or 7G2; or 3. To serve a cluster development that meets all requirements of Objective 2K3d.

Policy 6H1: To protect, restore, or enhance sensitive environmental resources of the Highlands Region, including but not limited to Forests, Critical Habitat, Highlands Open Waters and their buffers, Riparian Areas, Steep Slopes, Prime Ground Water Recharge Areas, Wellhead Protection Areas, and Agricultural Resource Areas.

Policy 6N4: To require through Plan Conformance that municipalities and counties adopt LID best management practices where disturbance of Highlands resources is proposed, including but not limited to Steep Slopes, forest resources, Critical Habitat, Highlands Open Waters and Riparian Areas, and Prime Ground Water Recharge Areas.



Net Water Availability
 STATE ROUTE 173, BETHLEHEM TOWNSHIP, Hunterdon County, Block 00026, Lot 00002
 11/23/2009

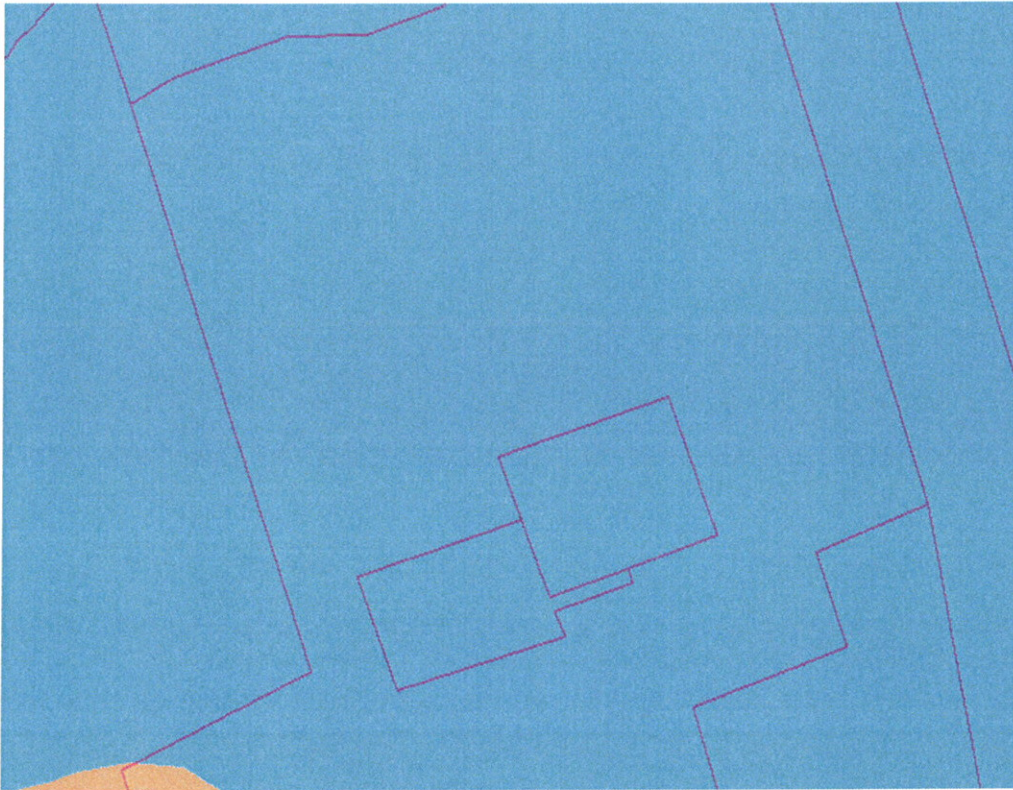

Net Water Availability is calculated for each HUC14 subwatershed by deducting consumptive and depletive water uses from Ground Water Availability. The Regional Master Plan incorporates Net Water Availability as a capacity threshold on future water uses. Where Net Water Availability is positive, it is assumed there is water available beyond the existing demand. Where net water availability is negative, the subwatershed is in deficit and deemed to be a Current Deficit Area. In Current Deficit Areas where a Water Use and Conservation Management Plan has not yet been adopted, limited amounts of Conditional Water Availability are provided. The use of Net Water Availability or Conditional Water Availability is subject to Regional Master Plan policies.

Policy 2A2: To ensure that increasing water demands do not exceed Net Water Availability or exacerbate existing deficits of subwatersheds. Net Water Availability is affected at a subwatershed level by location and extent of Land Use Capability Zone Map and its status as Current Deficit Area or Existing Constrained Area.

Objective 2B4c: Establish and implement mandatory stormwater reuse for recreational and other non-agricultural irrigation, as well as other non-potable water purposes to minimize both the volume of stormwater discharges and water withdrawals for these purposes.

Policy 2B7: To ensure through Plan Conformance (including through a Water Use and Conservation Plan developed under Objective 2B8c), local development review, and Highlands Project Review that the use of Net Water Availability and Conditional Water Availability within each subwatershed supports development patterns that are in conformance with RMP policies and objectives.

Objective 2B8c: Water Use and Conservation Management Plans shall be required through municipal Plan Conformance for all subwatersheds to meet the policies and objectives of Goal 2B, to ensure efficient use of water through water conservation and Low Impact Development Best Management Practices, and to avoid the creation of new deficits in Net Water Availability. Where developed for Current Deficit Areas, the plans shall include provisions to reduce or manage

consumptive and depletive uses of ground and surface waters as necessary to reduce or eliminate deficits in Net Water Availability, or to ensure continued stream flows to downstream Current Deficit Areas from Existing Constrained Areas, to the maximum extent practicable within each HUC14 subwatershed. Water Use and Conservation Management Plans shall demonstrate through a detailed implementation plan and schedule how and when the current deficit will be resolved in a subwatershed prior to approval for new water uses in the subwatersheds with the most severe deficits (i.e., in excess of 0.25 million gallons per day), and the plan shall be implemented prior to initiation of new water uses.

Objective 2J2b: Limit future water system demands to levels that will not create a Current Deficit Area where one does not currently exist.



Existing Constrained Areas

STATE ROUTE 173, BETHLEHEM TOWNSHIP, Hunterdon County, Block 00026, Lot 00002

11/23/2009

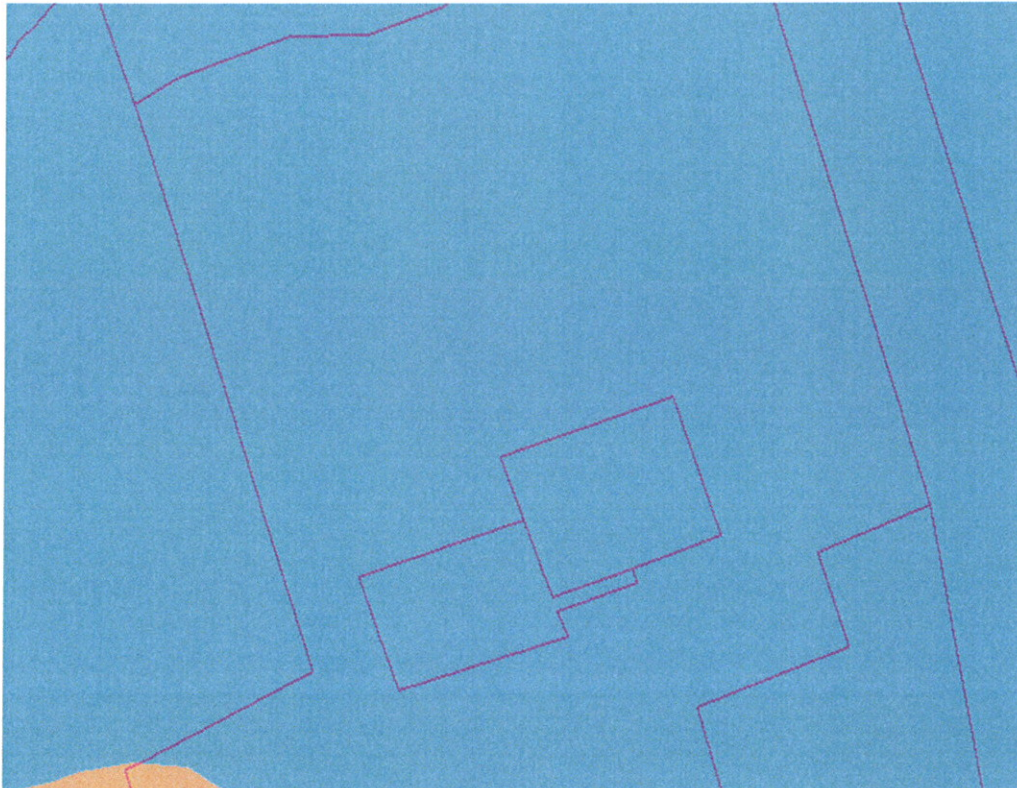

Net Water Availability by HUC14:

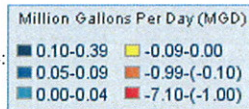

Identifies HUC14 subwatersheds that are upstream of a Current Deficit Area. The maintenance of stream flows in Existing Constrained Areas is necessary to ensure that downstream deficits are not exacerbated.

Objective 2B8c: Water Use and Conservation Management Plans shall be required through municipal Plan Conformance for all subwatersheds to meet the policies and objectives of Goal 2B, to ensure efficient use of water through water conservation and Low Impact Development Best Management Practices, and to avoid the creation of new deficits in Net Water Availability. Where developed for Current Deficit Areas, the plans shall include provisions to reduce or manage consumptive and depletive uses of ground and surface waters as necessary to reduce or eliminate deficits in Net Water Availability, or to ensure continued stream flows to downstream Current Deficit Areas from Existing Constrained Areas, to the maximum extent practicable within each HUC14 subwatershed. Water Use and Conservation Management Plans shall demonstrate through a detailed implementation plan and schedule how and when the current deficit will be resolved in a subwatershed prior to approval for new water uses in the subwatersheds with the most severe deficits (i.e., in excess of 0.25 million gallons per day), and the plan shall be implemented prior to initiation of new water uses.

Objective 2J2a: Limit future water system demand and reduce existing demand where feasible by water systems that are dependent on Current Deficit Areas or Existing Constrained Areas as a source of water.

Objective 2J2b: Limit future water system demands to levels that will not create a Current Deficit Area where one does not currently exist.



Prime Ground Water Recharge Area

STATE ROUTE 173, BETHLEHEM TOWNSHIP, Hunterdon County, Block 00026, Lot 00002

11/23/2009

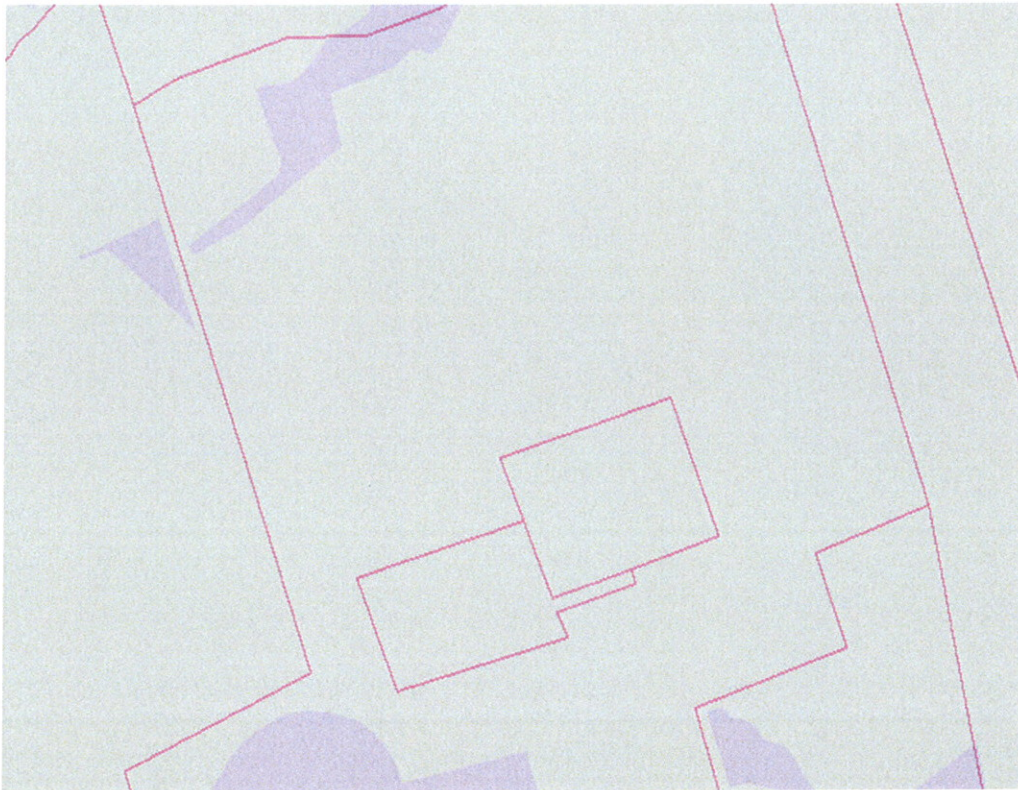

Prime Groundwater Recharge Area: ■

The layer displays the mapping of Prime Ground Water Recharge Areas. The Regional Master Plan defines Prime Ground Water Recharge Areas as those lands within a HUC14 subwatershed that most efficiently provide 40% of total drought recharge volume for that HUC14 subwatershed, using a GSR-32 analysis based upon land cover and the 1964-1966 drought of record precipitation.

Policy 2D3: To protect, enhance, and restore the quantity and quality of Prime Ground Water Recharge Areas.

Objective 2D3c: Implement master plans and development review ordinances through Plan Conformance that protect Prime Ground Water Recharge Areas and minimize the potential for disruption of recharge in such areas by development.

Objective 2D3g: Require through Plan Conformance and local health ordinances, that existing land uses that have a significant potential to result in major discharges of pollutants to ground water or to the land surface (including but not limited to non-sanitary wastewater effluent and any major sources of potential discharges such as spills and leaks), such that they may degrade ground water quality within a Prime Ground Water Recharge Area, shall incorporate ongoing management of toxic chemical sources and prohibition of unregulated discharges, so that the potential for ground water contamination is minimized and the opportunity for discharge discovery and control is maximized.

Policy 2D4: To apply standards through Plan Conformance, local development review and Highlands Project Review to protect, restore and enhance the functionality and the water resource value of Prime Ground Water Recharge Areas by restricting development and uses of land within a Prime Ground Water Recharge Area that reduce natural ground water recharge volumes or may directly or indirectly contribute to or result in water quality degradation.

Objective 2D4a: Development shall not occur in Prime Ground Water Recharge Areas unless necessary to avoid Critical Habitat, Highlands Open Waters Buffers and Moderately and Severely Constrained Steep Slopes.



Agricultural Resource Area

STATE ROUTE 173, BETHLEHEM TOWNSHIP, Hunterdon County, Block 00026, Lot 00002
11/23/2009

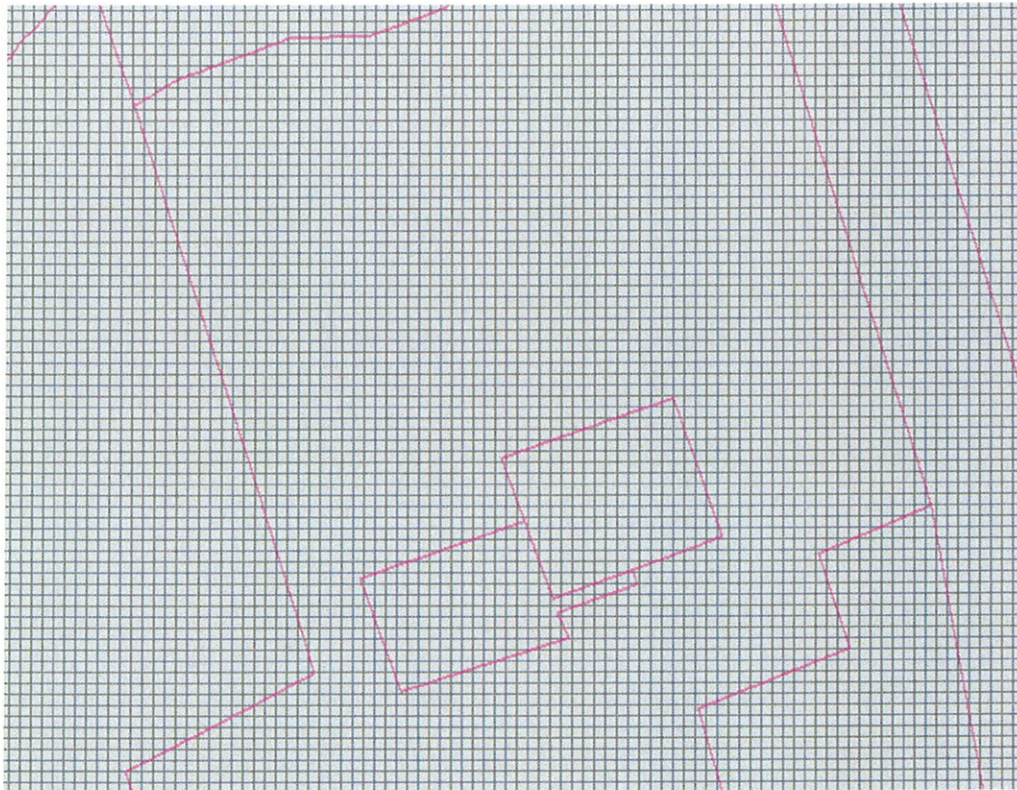

Agricultural Resource Area:■

An intensity indicator that reflects areas in the Region with a prevalence of active farms and is based upon Contiguous Farms >250 acres, Important Agricultural Soils - Undeveloped, and Preserved Farms data layers.

Objective 113: To require conforming municipalities and counties to require conservation or land stewardship easements, enforceable by the Highlands Council and at least one of the following: the appropriate municipality, the County Agriculture Development Board, the SADC, Green Acres, or a non-profit land trust organized pursuant to 501 (c)(3) of the federal tax code and engaged in the protection of land for the purpose of providing long-term stewardship of important resources as a condition of development approval for lands within parcels proposed for development that are identified for preservation on a proposed site plan or subdivision plot.

Objective 2J4b: Clustered development served by public water supply within the Protection Zone, the Conservation Zone, and the Environmentally-Constrained Sub-zones of the Planning Area shall be approved only if the following conditions are met: 1. The development impacts are otherwise consistent with the requirements of the RMP, including provisions for mandatory clustering in Agricultural Resource Areas pursuant to Policy 3A5; 2. Extension of an existing public water system will occur only where the cluster development is within or immediately adjacent to an Existing Area Served with available capacity; 3. Creation of a new public water system will occur only where such development is not within or immediately adjacent to an Existing Area Served with available capacity; 4. The clustered development preserves at least 80% of the cluster project area in perpetuity for environmental protection or agricultural purposes. To the maximum extent feasible the developed portion (i.e., not including wetlands, Highlands Open Waters buffers, and recreational lands) occupies no more than 10% of the cluster project area if served by a public or community on-site wastewater system; and 5. Where the preserved land in the cluster project area is dedicated to agricultural purposes, the cluster development ordinance and an Agriculture Retention/Farmland Preservation Plan supports continued agricultural viability of the agricultural land and requires the implementation of best management practices, including development and implementation of a Farm Conservation Plan that addresses the protection of water and soil resources prepared by the USDA Natural Resources Conservation Service (NRCS), Technical Service Provider (TSP), appropriate agent or NJDA staff, and approved by the local Soil Conservation District (SCD).

Objective 2K3c: Prohibit new, expanded or extended public wastewater collection and treatment systems and community on-site treatment facilities within the Protection Zone, the Conservation Zone and the Environmentally-Constrained Sub-zones of the Planning Area unless they are shown to be necessary for and are approved by the Highlands Council for one or more of the purposes listed below. For approvals regarding parts 1, 2, and 3, the project must maximize the protection of sensitive environmental resources such as Highlands Open Waters buffer areas, Riparian Areas, the forested portion of the Forest Resource Area, agricultural lands of Agricultural Resource Areas, Steep Slopes, Prime Ground Water Recharge Areas and Critical Habitat. For approvals regarding part 3, the project must avoid disturbance of Highlands Open Waters buffer areas, Riparian Areas, Steep Slopes and Critical Habitat, and must minimize disturbance of the forested portion of the Forest Resource Area, agricultural lands of Agricultural Resource Areas, and Prime Ground Water Recharge Areas. The choice of extension or creation of systems shall follow the requirements in Objective 2K3d (2 and 3). The applicable purposes are: 1. To address through a waiver under Policy 7G1 or 7G2 a documented existing or imminent threat to public health and safety from a pattern of failing septic systems (where the failing systems cannot reasonably be addressed through rehabilitation or replacement) or highly concentrated septic systems, where the threat is of sufficient scale to justify a public wastewater collection and treatment system or community on-site treatment facility and where no alternative is feasible that would sufficiently assure long-term protection of public health and safety. To address other issues of public health and safety, such needs shall have highest priority for allocation of existing system capacity; 2. To address development permitted through a Highlands Redevelopment Area or takings waiver under Policy 7G1 or 7G2; or 3. To serve a cluster development that meets all requirements of Objective 2K3d.



Within Half Mile of Freight Rail Network

STATE ROUTE 173, BETHLEHEM TOWNSHIP, Hunterdon County, Block 00026, Lot 00002
11/23/2009

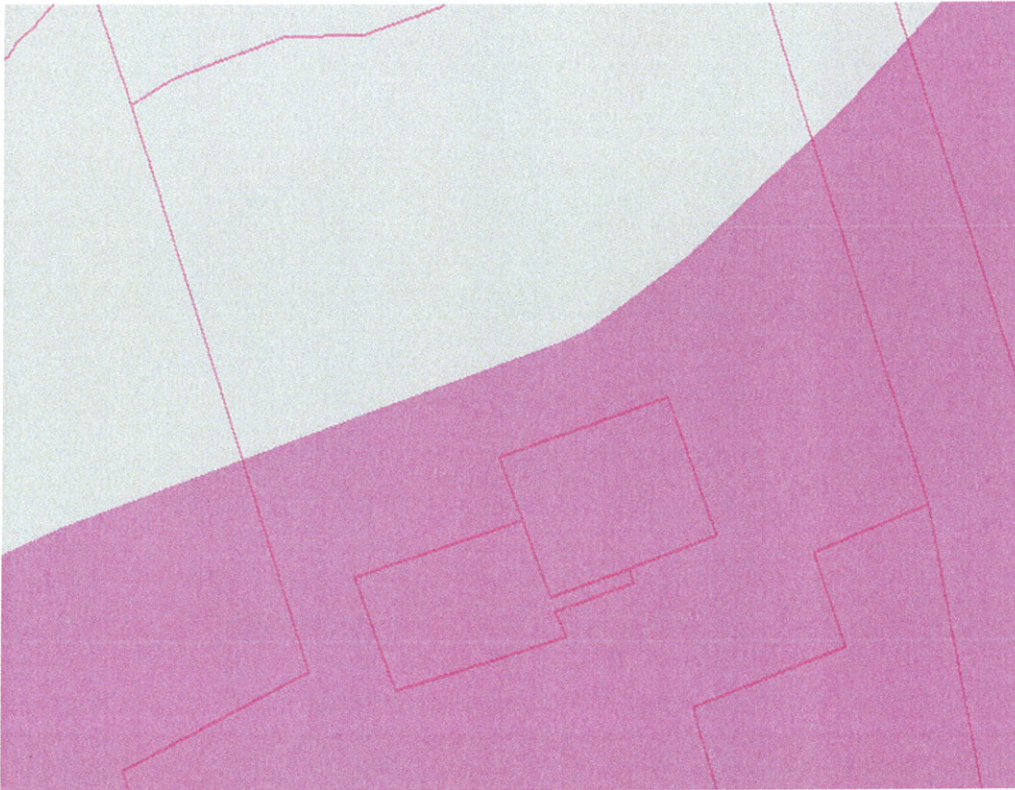

Within Half Mile of Freight Rail Network: ■

Includes all developed lands within a 1/2 mile buffer from all freight rail networks.

Objective 5A2a: Encourage the movement of goods from the roadway network to the freight rail network wherever possible.



Preservation Area

STATE ROUTE 173, BETHLEHEM TOWNSHIP, Hunterdon County, Block 00026, Lot 00002

11/23/2009

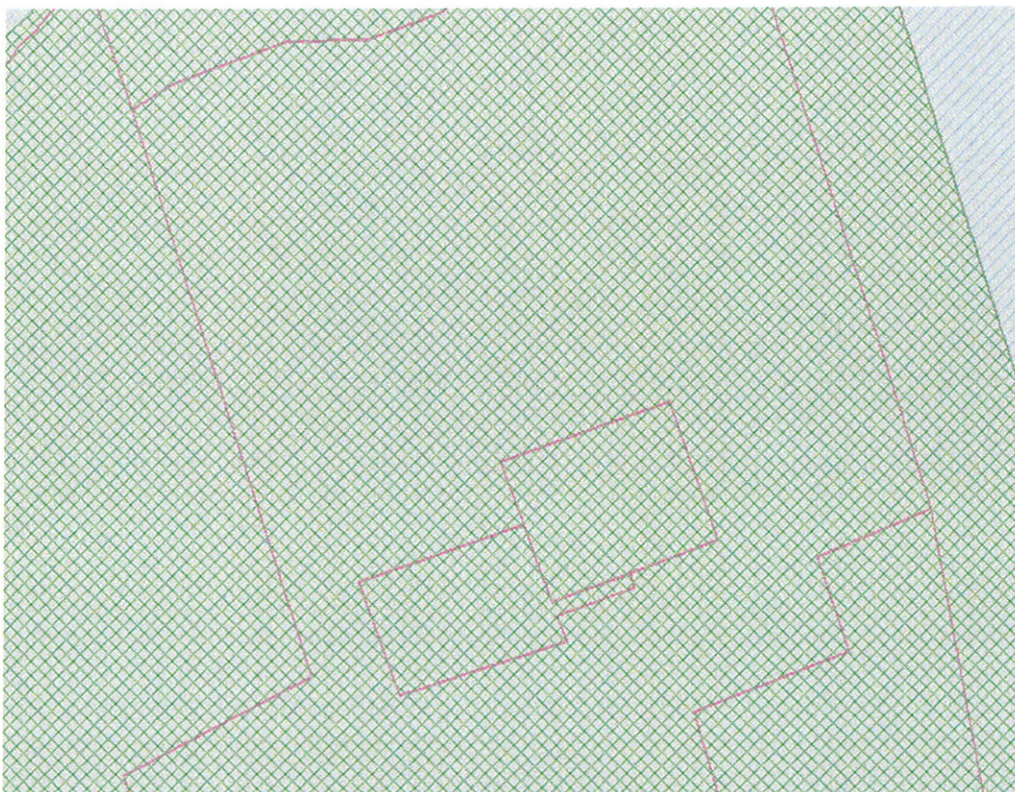

Planning Area / Preservation Area: Planning Area Preservation Area

Means those lands within the Highlands Region which are designated as the Preservation Area by the Highlands Act (N.J.S.A 13:20-7b).

Policy 2I1: To prohibit the expansion or creation of public water supply systems, public wastewater collection and treatment systems and community on-site treatment facilities in the Preservation Area unless approved through a Highlands Applicability Determination (HAD) or a HPAA with waiver pursuant to N.J.A.C. 7:38 and Policy 7G1.

Objective 2I1a: Designated sewer service areas in the Preservation Area shall be restricted to the Existing Area Served as of August 10, 2004, except to serve development that is approved through a HAD or a HPAA with waiver pursuant to N.J.A.C. 7:38 and Policy 7G1.

Objective 2I1b: The expansion or creation of public water supply systems, public wastewater collection and treatment systems and community on-site treatment facilities in the Preservation Area as approved through a HPAA with waiver pursuant to N.J.A.C. 7:38 and Policy 7G1 shall maximize the protection of sensitive environmental resources including avoidance of Highlands Open Waters buffer areas, Riparian Areas, the forested portion of the Forest Resource Area, agricultural lands of Agricultural Resource Areas, Steep Slopes, Prime Ground Water Recharge Areas, and Critical Habitat.

Objective 2L2c: Use the NJDEP Highlands Preservation Area rules and nitrate thresholds for the Preservation Area.

Policy 6J1: To encourage Preservation Area redevelopment of sites with 70% or greater impervious surfaces or a brownfield in areas designated by the Highlands Council as Highlands Redevelopment Areas in accordance with N.J.A.C 7:38-6.6 and 6.7.

Objective 7F1c: Preservation Area exemptions issued by the NJDEP in accordance with N.J.A.C. 7:38, shall be required, where appropriate, prior to consideration of a local development review or a Highlands Project Review. Guidance shall specify the exceptions where a review may proceed

absent an exemption determination from the NJDEP.

Policy 7G1: For the Preservation Area, coordinate with NJDEP during Highlands permit review for any major Highlands development including the review of waivers on a case-by-case basis: 1) if determined to be necessary in order to protect public health and safety; 2) for redevelopment in certain previously developed areas as identified by the Highlands Council, or 3) in order to avoid the taking of property without just compensation.



Protection Zone

STATE ROUTE 173, BETHLEHEM TOWNSHIP, Hunterdon County, Block 00026, Lot 00002
11/23/2009

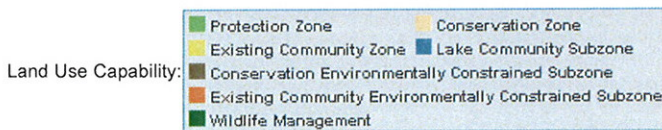

Consists of high natural resource value lands that are important to maintaining water quality, water quantity and sensitive ecological resources and processes.

Policy 6C1: To limit new human development in the Protection Zone to redevelopment, exempt activities, and environmentally-compatible low density new land uses, in accordance with RMP resource protection needs and water quality and quantity capacity constraints and to ensure that the impacts of development using exemptions under the Highlands Act (see Policy 7F1) are considered in regional protection measures.

Objective 6C1a: Centers in the Protection Zone, potentially including clustered development, shall be at densities appropriate to the Zone, the community character, the State Development and Redevelopment Plan, and the use of septic systems or community wastewater systems.

Policy 6C2: To ensure through Plan Conformance, local development review and Highlands Project Review that any future development or redevelopment which does occur in a Protection Zone is subject to standards and criteria which protect the land and water resources of the Protection Zone from any potential adverse impact to the maximum extent possible.



Conservation Zone

STATE ROUTE 173, BETHLEHEM TOWNSHIP, Hunterdon County, Block 00026, Lot 00002
11/23/2009

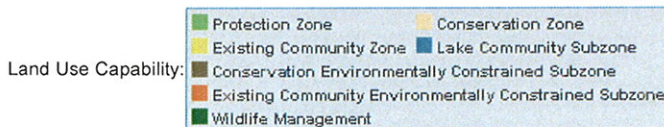

Consists of areas with significant agricultural lands and interspersed with associated woodlands and environmental features.

Objective 2B4d: The highest priority for agricultural water uses in the Conservation Zone shall be those Preservation Area uses that promote agricultural and horticultural uses and opportunities that are compatible with protection of the Highlands environment, and those Planning Area uses that promote the continuation and expansion of agricultural, horticultural, recreational, and cultural uses and opportunities. Compatible agricultural and horticultural uses shall minimize consumptive water uses through efficiency measures.

Policy 6D3: To limit through Plan Conformance, local development review and Highlands Project Review the use and development of lands within the Conservation Zone to agriculture use and development, including ancillary and support uses, redevelopment of existing developed areas, and environmentally-compatible low density land uses that are to the maximum extent possible achieved in compact development patterns, to be designed and developed in a manner which is compatible with the long term use of adjacent land for agricultural purposes.

Objective 6D3b: Centers in the Conservation Zone, potentially including clustered development, shall be at densities appropriate to the Zone, the community character, the State Development and Redevelopment Plan, and the use of septic systems or community wastewater systems.



Conservation or Protection Zone

STATE ROUTE 173, BETHLEHEM TOWNSHIP, Hunterdon County, Block 00026, Lot 00002

11/23/2009



Protection Zone	Conservation Zone
Existing Community Zone	Lake Community Subzone
Conservation Environmentally Constrained Subzone	Existing Community Environmentally Constrained Subzone
Wildlife Management	

Includes both the Conservation Zone and the Protection Zone.

Objective 2L3f: Carrying capacity shall be documented through the Land Use Capability Septic System Yield Map as the number of allowable septic systems per Conservation and Protection Zone for each HUC14 subwatershed, taking into account the nitrate target, the HUC14 subwatershed drought ground water recharge, and the acreage that is privately owned, undeveloped or underdeveloped, and not preserved.



Policies and Objectives not Associated with Features
11/23/2009

Includes both the Conservation Zone and the Protection Zone.

Objective 2L3f: Carrying capacity shall be documented through the Land Use Capability Septic System Yield Map as the number of allowable septic systems per Conservation and Protection Zone for each HUC14 subwatershed, taking into account the nitrate target, the HUC14 subwatershed drought ground water recharge, and the acreage that is privately owned, undeveloped or underdeveloped, and not preserved.
